

EN

EP.V.34660.03 | 07/2023

asecos®

USER MANUAL

Recirculating air filter unit
UFA.025.030(XL)

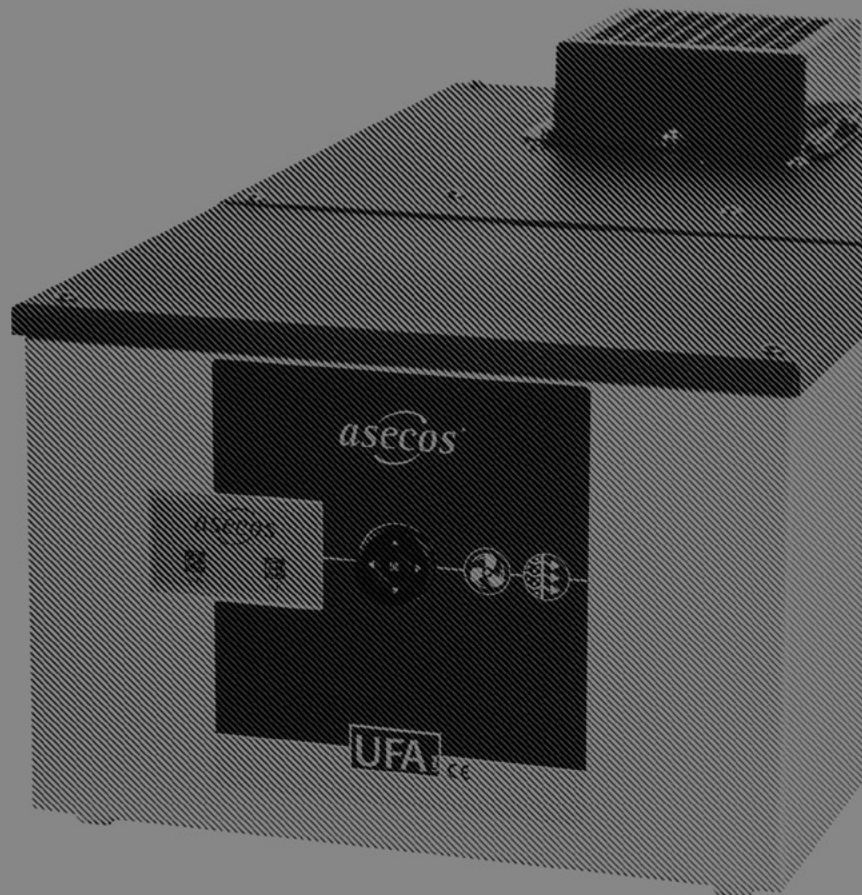

1. NOTES ▪ GUIDELINES ▪ GUARANTEE	3
1.1. General safety notes	3
1.2. Guarantee	3
1.3. Development and Manufacturer	3
1.4. Purpose of use	3
2. CONSTRUCTION AND FUNCTION	4
2.1. Material	4
2.2. Accessories	4
2.3. Mode of operation	4
2.4. Ventilation setting / monitoring	4
2.5. Potential-free alarm contact	5
3. ERECTION ▪ COMMISSIONING	5
3.1. Commissioning	5
3.2. Self-test	6
4. DISPLAY AND MENU	6
4.1. Power indicator	6
4.2. Overview of the menu icons	7
4.3. Show system information	7
4.4. Set display contrast	8
5. MALFUNCTIONS ▪ ACTIONS	8
6. REPAIRS	9
7. FUNCTIONAL CHECK ▪ MAINTENANCE ▪ CARE	9
7.1. Sensors and monitoring electronics	9
7.2. Cleaning	9
8. TECHNICAL DATA	10
9. TECHNICAL DRAWING	10
10. ATEX MARKING	11

1.1. GENERAL SAFETY NOTES

- Observe applicable statutes and regulations, and the notes in these operating instructions, when handling hazardous materials
- Only use the recirculation filter attachment when it is in proper condition
- Please follow the instructions of the safety experts, technical supervisory services (BG, GAA, pharmacy equipment) of the construction supervision, etc.
- Observe accident prevention regulations and workplace ordinance
- Check the recirculation filter attachment regularly for proper function (exhaust air volume flow and filter saturation by checking the indicators)

1.2. GUARANTEE

The guarantee for this product is agreed between you (the customer) and your dealer (the seller). As the manufacturer, asecos guarantees the products listed in the operating instructions for a period of 24 months from the date of delivery. All model safety equipment are subject to a compulsory annual inspection by specialised staff authorised by the manufacturer. Otherwise the customer's guarantee claim against the manufacturer expires.

1.3. DEVELOPMENT AND MANUFACTURER

asecos GmbH, Weierfeldsiedlung 16-18, 63584 Gründau, Germany
 The type plate with the serial number is located on the outside of the unit's housing

1.4. PURPOSE OF USE

The unit is used for technical ventilation from Ex zone 2 or no Ex zone of safety cabinets used for storing flammable liquids. The recirculation filter attachment is particularly low-noise and therefore ideal for use directly in the working environment.

Suitable for cabinet models:

UFA Model	Suitable cabinet groups
UFA.025.030	S-LINE / Q-LINE / V-LINE / UB-LINE / CS.195.105.F / E.195.105.F
UFA.025.030.XL	XL-LINE / S-CLASSIC-30

Set-up requirements

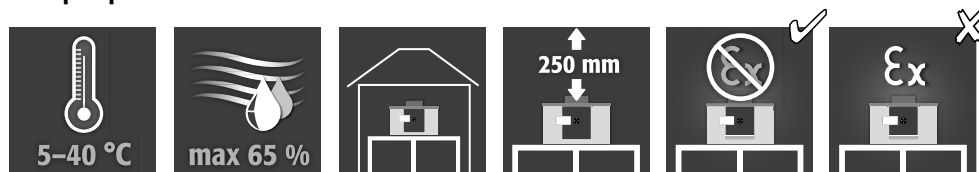

CAUTION:

The unit may only be installed in a non-hazardous area!

The integrated activated carbon filter removes 99.999% of the hydrocarbons from the exhaust air so that it can be discharged directly into the room air. The pollutant-containing exhaust air stream does not come into contact with electrical current-carrying components. The unit is therefore suitable for exhausting cabinets that are defined in EN 14470 Part 1 or DIN 12925 Part 1. An exhaust duct leading to the outside at a non-hazardous location can therefore be omitted. A CE certificate of conformity (also according to EC Directive 2014/34/EU - ATEX Directive) is available.

2. CONSTRUCTION AND FUNCTION

2.1. MATERIAL

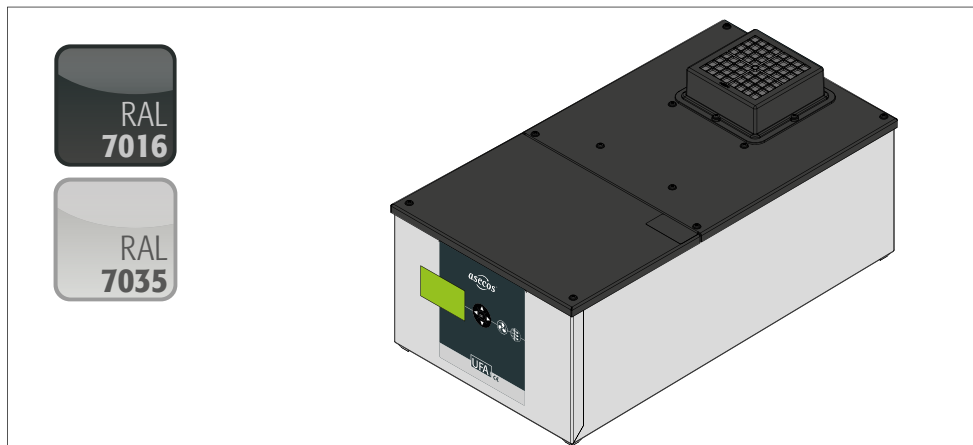

INFO:

The housing is made of powder-coated fine sheet steel

2.2. ACCESSORIES

- Activated carbon main filter incl. suspended matter pre-filter (order no. 40201), housing ABS/galvanised sheet steel, filling activated carbon (approx. 3500 gr).
- Secondary filter (order no. 40200), ABS housing, ABEK activated carbon filling (140 g) incl. suspended matter prefilter

2.3. MODE OF OPERATION

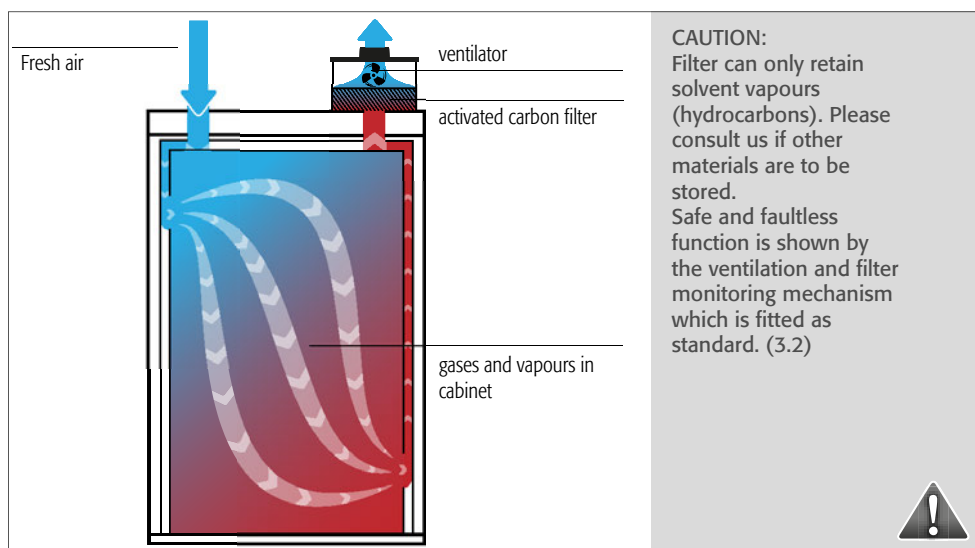

CAUTION:
Filter can only retain solvent vapours (hydrocarbons). Please consult us if other materials are to be stored.
Safe and faultless function is shown by the ventilation and filter monitoring mechanism which is fitted as standard. (3.2)

2.4. VENTILATION SETTING / MONITORING

The performance of the fan is sufficient to achieve an air exchange rate of at least 10 times for the cabinet models listed under point 1.3. The proper ventilation function is independently controlled by an electronic monitoring system. The air volumes are monitored in the exhaust air shaft by means of pressure differential measurement. An optical and acoustic alarm is triggered when the air exchange rate falls below the set value. The visual alarm only goes out when the setpoint is reached again, the acoustic alarm can be cancelled by pressing the "OK button" be interrupted.

2.5. POTENTIAL-FREE ALARM CONTACT

To use the potential-free alarm contact, the three-pole plug supplied must be used. The contact is designed for a maximum direct voltage of DC 30 V or an alternating voltage of AC 230 V. The maximum current carrying capacity is 10 A.

The plug is connected according to the following diagram:

Contact position

Normal operation: "L" and "1" are connected

Alarm or mains failure: "L" and "2" are connected

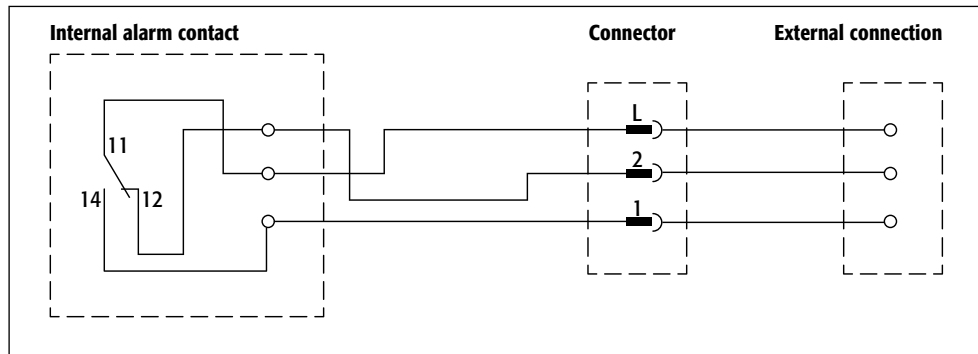

CAUTION:

The potential-free alarm contact must not be used to switch large loads. It is only intended to signal a malfunction of the recirculation filter attachment by means of a signal light, horn or similar.

The connection must be carried out by a qualified electrician!

3. ERECTION - COMMISSIONING

3.1. COMMISSIONING

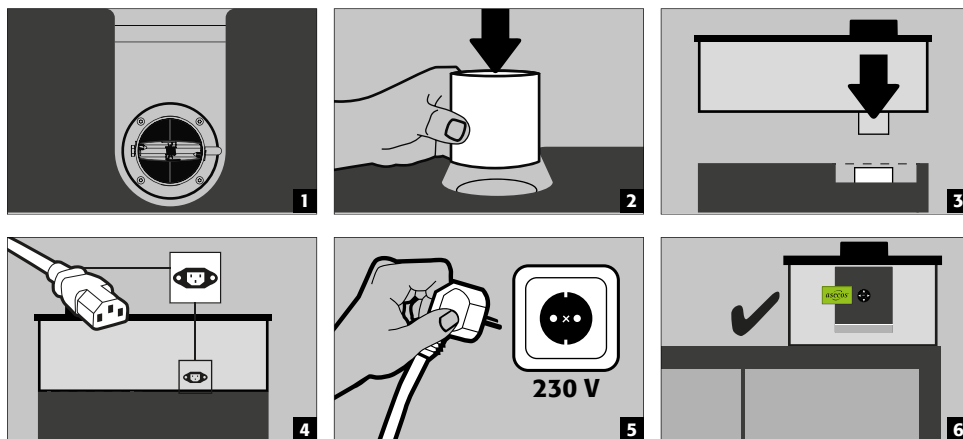

ATTENTION:

Observe the instructions point **1.4 Intended use**

3.2. SELF-TEST

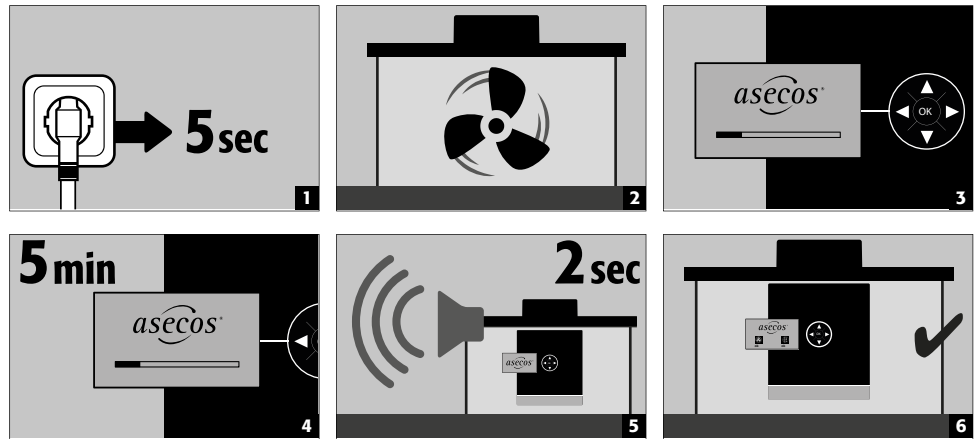

ATTENTION:

The unit is designed for continuous operation!



PLEASE NOTE:

As soon as the unit is connected to the mains, a self-test begins during which all safety-relevant components are checked. If there is a fault, the unit will not start. An error F7 is displayed alternating with the relevant faulty safety element F1-F4.

4. DISPLAY AND MENU

4.1. POWER INDICATOR

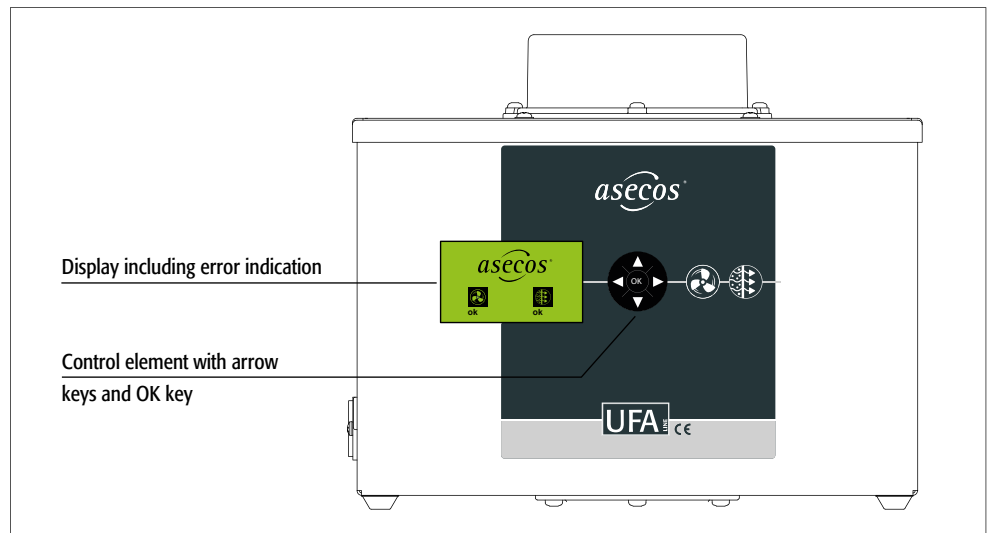

IN THE EVENT OF A MALFUNCTION:

Measures see 6. malfunctions

4.2. OVERVIEW OF THE MENU ICONS

Symbols in the active screen

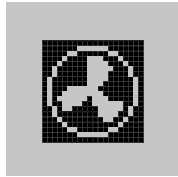

Volume flow OK

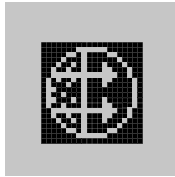

Filter saturation OK

Symbols in the main menu

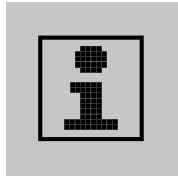

Information

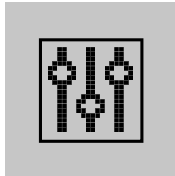

Settings submenu

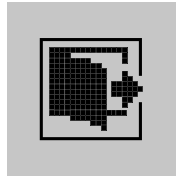

Exit current display

Symbols in the Settings menu and sub-items

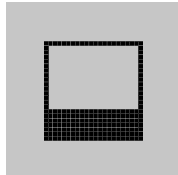

Set contrast

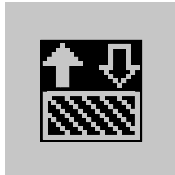

Carry out filter change

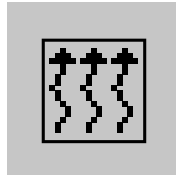

Set air monitoring parameters

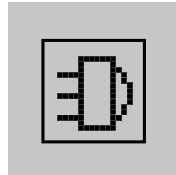

Replace sensor

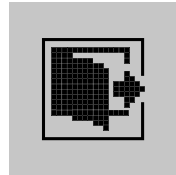

Exit current display

4.3. SHOW SYSTEM INFORMATION



ATTENTION:

For a simplified service procedure, please have the system information ready.

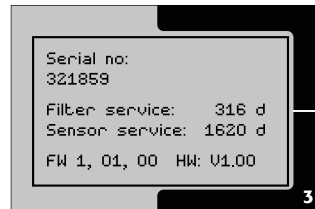
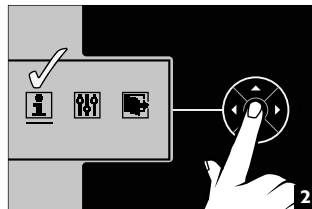
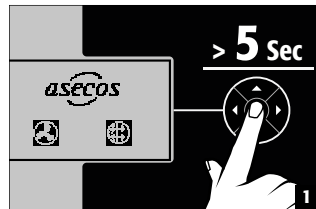

NOTE

The system automatically switches to the normal display when there is no activity or no input.



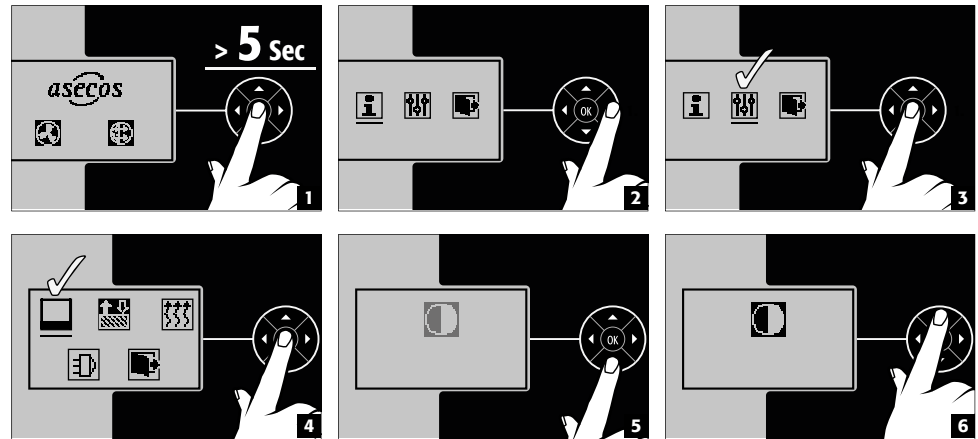













4.4. SET DISPLAY CONTRAST















NOTE

The system automatically switches to the normal display when there is no activity or no input.

5. MALFUNCTIONS - ACTIONS

Malfunction	Problem - Measure	Note - be sure to observe!
  AL 1	Pressure difference across the filter too low. (Fan defective or air outlet blocked).	Please check the air outlet. Please contact your specialist dealer or our service hotline 01805 - 92 20 92
  AL 2	Pressure difference over the filter too high. (filter too dirty, air flow rate too low).	Main filter change necessary! Please contact your specialist dealer or our service hotline 01805 - 92 20 92.
  AL 3	The filter is almost completely saturated, a timely change is necessary.	Attention: Possible accident inside the cabinet! Eliminate leakage professionally and change filter! Please contact your specialist dealer or our service hotline 01805 - 92 20 92
  AL 4	The filter is completely saturated and the fan has been switched off. It is now imperative to change the filter at short notice.	Main filter and secondary filter change necessary! Please contact your specialist dealer or our service hotline 01805 - 92 20 92
  W 1	The filter is close to its saturation limit, a timely change is imperative.	Please contact your responsible specialist dealer or to our service hotline 01805 - 92 20 9
  Ser 1	Filter runtime longer than 8040 operating hours (11 months) The permissible operating time of the filter has almost expired. The filter must now be changed at short notice.	Please contact your responsible specialist dealer or to our service hotline 01805 - 92 20 9
  Ser 2	Filter runtime longer than 8760 operating hours (12 months) The permissible operating time of the filter has expired. The filter must now be changed at short notice.	Please contact your responsible specialist dealer or to our service hotline 01805 - 92 20 9
  Ser 3	Filter sensor runtime longer than 48 months A sensor replacement should be carried out in the course of the next safety inspection.	Please contact your responsible specialist dealer or to our service hotline 01805 - 92 20 9

  Ser 4	Running time of the filter sensor longer than 54 months. Sensor drift and thus safe operation can no longer be guaranteed. The sensor must be replaced.	Please contact your responsible specialist dealer or to our service hotline 01805 - 92 20 9
  F 1	Differential pressure sensor error	Please contact your responsible specialist dealer or to our service hotline 01805 - 92 20 9
  F 2	Error temperature/humidity sensor	Please contact your responsible specialist dealer or to our service hotline 01805 - 92 20 9
  F 3	Filter sensor defective	Please contact your responsible specialist dealer or to our service hotline 01805 - 92 20 9
  F 4	Fan defective (blocked)	Please contact your responsible specialist dealer or to our service hotline 01805 - 92 20 9
  F 7	Self test error Display F7 alternating with the respective error F1 to F4	Please contact your responsible specialist dealer or to our service hotline 01805 - 92 20 9

14 ct/called minute from the Deutsche Telekom AG fixed network, from mobile phones a maximum of 42 ct/minute.

6. REPAIRS



ATTENTION
 Repairs are only to be carried out by specialists specifically trained for this.
 Given damage the appliance is to be repaired or replaced by the manufacturer.

7. FUNCTIONAL CHECK - MAINTENANCE - CARE

To ensure safety, the recirculation filter attachment should be serviced at least once a year and its function checked by a specialist. At the same time, the built-in filter unit must be replaced at least once a year, and immediately when the saturation limit is reached.
 The functionality is checked electronically by the integrated ventilation and filter saturation monitoring, so that a function check of the recirculation filter attachment is carried out permanently during operation. The activated charcoal main filter of the recirculation filter attachment must be replaced with a new filter at short notice if the corresponding maintenance indicator (red screen) is shown. The filter can only be replaced by one of our trained service technicians and must be requested promptly on the service hotline. Filter replacement by asecos service personnel ensures that the contaminated activated carbon is fed into a defined disposal chain.

7.1. SENSORS AND MONITORING ELECTRONICS

The UFA contains sensitive sensors and complex monitoring electronics. The device must be designed as a "continuous 24/7" and was also designed for this purpose. The sensitive gas sensor system in particular is heavily stressed by continuous operation and, according to experience, can deliver unreliable measurement results after a certain period of operation (drift) after approx. 40,000 operating hours.
 The UFA can then no longer be used safely (possible monitoring errors).
 In this case, a visual warning is given. In this case, please contact the customer service for replacement of the sensor unit.

7.2. CLEANING

For external cleaning of the recirculating air filter attachment, please use common, mild household cleaners and a soft cloth. **Disconnect your recirculating air filter attachment from the mains by unplugging the power cable before cleaning! Make sure that no moisture gets into the inside of the recirculating air filter attachment during cleaning.**

**CONTACT:**

In the case of defects or complaints about our products (within and also after the warranty period), and for requesting safety checks or taking out a service contract, please contact our service hotline on:

Tel: +44 1785 22 70-90 | info@asecos.co.uk (for great Britain and Ireland)

Tel: +49 1805 92 20 92 | service@asecos.com (international)

8. TECHNICAL DATA

		UFA.025.030	UFA.025.030.XL
External dimensions W x D x H		308 x 555 x 256	308 x 555 x 256
Nominal voltage	V	85-265	85-265
Frequency	Hz	50/60	50/60
Weight	kg	17	19
Power consumption in operation	W	8,5	8,5
Maximum current consumption	A	0.13	0.13
Volume flow	m ³ /h	10	24
Emission sound pressure level	dB	23.0	23.0
Potential-free alarm contact: maximum continuous current	A	10	10
Potential-free alarm contact: maximum nominal voltage AC	V	230	230
Potential-free alarm contact: maximum nominal voltage DC	V	30	30
Potential-free alarm contact: single-phase motor load	W	185	185
Potential-free alarm contact: max. switching capacity (electromagnetic)	VA	300	300
Potential-free alarm contact: max. switching capacity (ohmic)	VA	1500	1500

* including adapter

**PLEASE NOTE**

The data are approximate values and as such are not to be used in the sense of guaranteed properties. They correspond to the state of the art at the time of publication of the operating instructions. Further technical development expressly permits changes to these values without prior notice.

9. TECHNICAL DRAWING

- 1** ventilator
- 2** Sensor
- 3** activated carbon filter
- 4** Activated carbon secondary filter
- 5** Potential-free alarm contact

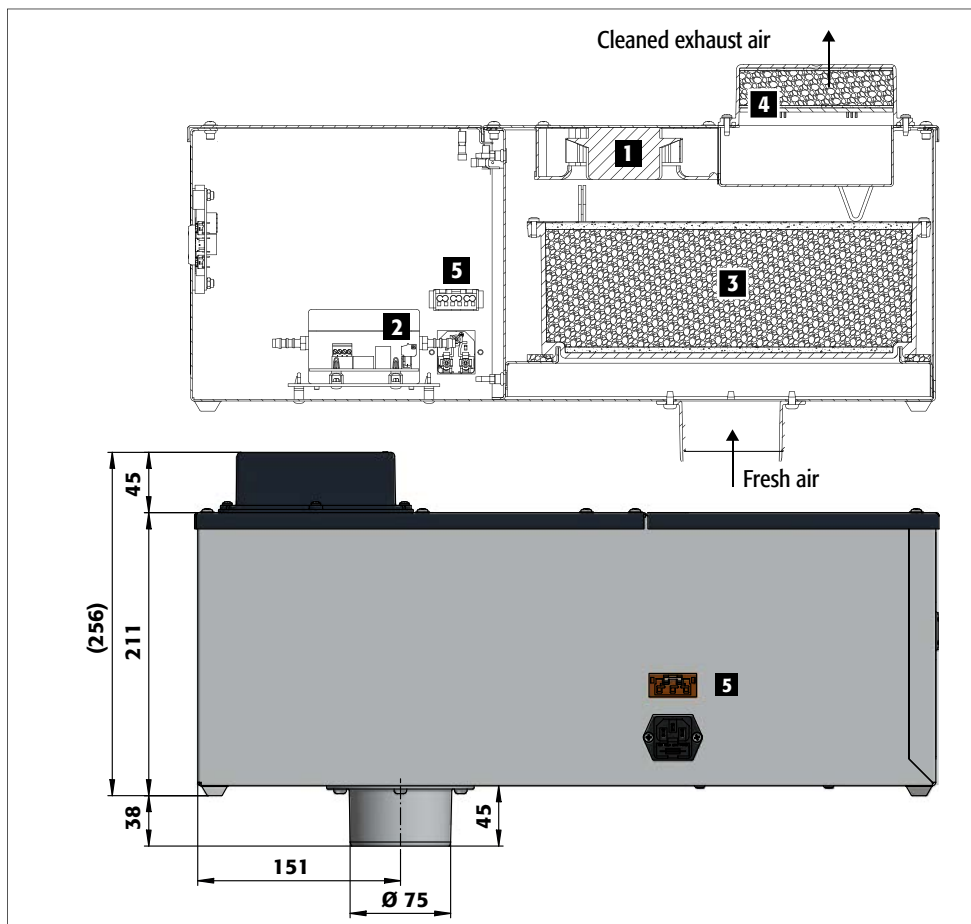



1 Marking of EX-protected units

2 Equipment group according to RL 2014/34/EU

II Not underground operation

3 Unit categories of the assemblies used

3/- Extraction from EX zone 2, installation exclusively in no EX zone

G Gas

4 Ignition protection types

Ex ic Intrinsic safety with the protection level "ic" - not capable of causing ignition in undisturbed operation

nA non-functioning

5 Explosion groups according to EN 60079-0: 2019-09

IIB the group has a limiting gap width (MESG) 0.5-0.9 mm, suitable e.g. for use with ethylene

6 Temperature class

T4 max. surface temperature of the operating medium 135 °C

7 Protection level EPL according to EN 60079-0: 2019-09

3/- G Gc Suitability for extraction from EX zone 2

